



J. STEPHEN Lab., Ltd.

374-2, Gajang-dong, Osan-si, Gyeonggi-do, 447-210, Korea
TEL : +82-31-459-8200 FAX : +82-31-459-8880
www.miniprinter.com



MODEL : LK-P20II

USER'S MANUAL



**RISK OF EXPLOSION IF BATTERY IS REPLACED BY AN INCORRECT TYPE.
DISPOSE OF USED BATTERIES ACCORDING TO THE INSTRUCTION**



Disposal of Old Electrical&Electronic Equipment(Applicable in the European Union and other European countries with separate collection systems)

This symbol on the product or on its packaging indicates that this product shall not be treated as household waste.

Instead it shall be handed over to the applicable collection point for the recycling of electrical and electronics equipment. For more detailed information about recycling of this product, please contact your local city office, your household waste disposal service or the shop where you purchased the product.

Table of Contents

1. Safety Caution	2
2. Unpacking	4
3. Product Overview	5
4. Usage and Installation	6
4-1. Control panel usage	6
4-2. Battery installation	7
4-3. Charging battery	8
4-4. Battery charger usage (<i>Optional</i>)	9
4-5. Usage of cigar jack for charging (<i>Optional</i>)	10
4-6. Battery removal	11
4-7. Belt clip usage	12
4-8. Loading the media.	13
4-9. Shoulder strap usage (<i>Optional</i>)	14
4-10. Leather case usage (<i>Optional</i>)	15
4-11. Self test	16
4-12. MSR usage (<i>Optional</i>)	18
4-13. IC CARD usage (<i>Optional</i>)	19
5. Peripherals Connection	20
5-1. Bluetooth connection (<i>Optional</i>)	20
5-2. Wi-Fi connection (<i>Optional</i>)	20
5-3. Interface cable connection	21
6. Printer Cleaning	22
7. Standard Roll Media Specification	23
8. Black Mark	24
9. Printer Specification	25
10. Certification	27
11. Setting up the Software	29

1. Safety Caution

For higher reliability and safety, consider the following precautionary measures. Read and follow the instructions carefully before running of the product.

Indication



Prohibition



Must follow



Do not disassemble



Unplug the power from the outlet



Grounding to prevent electric shock



Do not handle the product with wet hands



WARNING

Failure to follow these instructions could result in fire, electric shock, or other injuries, or property damage

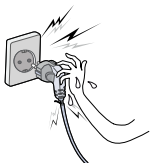

Do not pull or touch the power plug with wet hands.
(Potential risk of electric shock or fire)

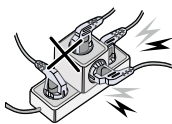

Do not overload the power plug into one outlet.
(Potential risk of electric shock or fire)



Do not bend the wire and do not allow the wire to be pressed by heavy object.
(Potential risk of electric shock or fire)

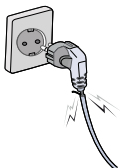

If a power plug is broken or a plug is cut or worn, do not use it.
(Potential risk of electric shock or fire)



WARNING

Failure to follow these instructions could result in fire, electric shock, or other injuries, or property damage

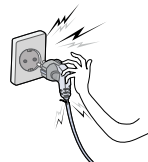

Do not pull out the power plug to turn off the product.
(Turn off the power at installation, transportation, wiring and inspection.)



Do not disassemble, repair or modify the product.
(Potential risk unit malfunction, electric shock or fire. When the product needs to be repaired, please contact in place where you ordered.inspection.)



CAUTION

Failure to follow these instructions could result in fire, electric shock, or other injuries, or property damage



Do not install the product in uneven or inclined surface.
(You may get hurt and it can be broken when it falls)



Keep product away from the water and other material.
(Potential risk of discoloration or electric shock)



If the product that needs to be repaired, please contact in place where you ordered.
(Potential risk of fire or unit malfunction)

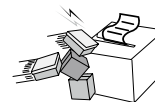

Please do not give excessive shock.
(Potential risk of fire or unit malfunction)

2. Unpacking

Standard



Printer



Battery

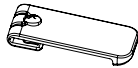

Belt Buckle

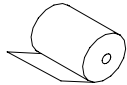

Roll Paper

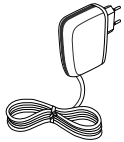

Charger

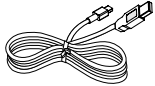

USB Cable



CD

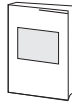

Quick Manual

Optional

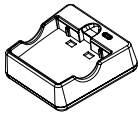

Battery Recharger

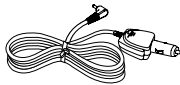

Cigar Jack Charger

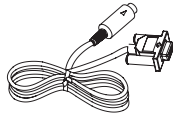

Serial Cable

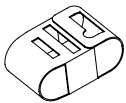

Printer Case

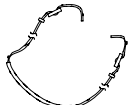

Strap

3. Product Overview

Front

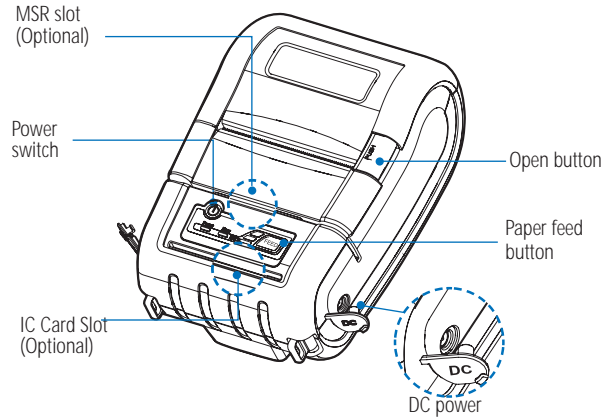



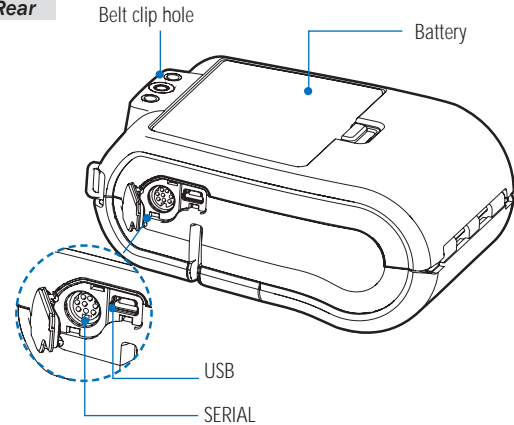

Rear

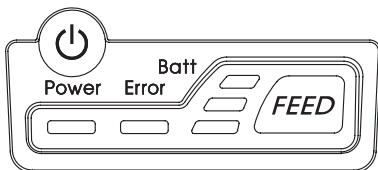

4. Usage and Installation

4-1 Control panel usage



Button	Name	function
	Power button	This button is used to turn the printer on and off. When the printer is off, press this button for approximately 3 seconds and it will turn on the power. When you press this button in a state that the printer is on, the printer will turn off.
	Paper feed button	Paper output can be done manually by pressing this button. Additionally, self-testing and Hexadecimal Dumping can be processed. 1. Refer to "4-11" for self test information. 2. Refer to the service manual regarding Hexadecimal Dumping.
	Battery status lamp	1. If the Batt, LED are Lit, the battery is fully charged. 2. If you can hear beeping sound and LED light is turned off, it means that the battery is at the lowest level. 3. If the battery is not charged at all, the printer turns off automatically.
	Error lamp	If the red light is turned on, it means there is no paper roll or the paper cover is open.

4-2 Battery Installation

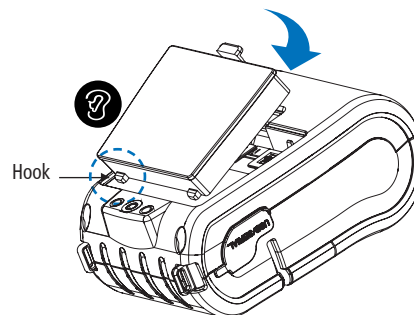

1. Align battery hook as shown in the picture
2. Push the battery into the printer until it locks in place.

NOTE

As the battery is not charged at the time of your purchase, charge the battery prior to using the printer
(Battery charger or Cradle can be used to charge)

4-3 Charging battery

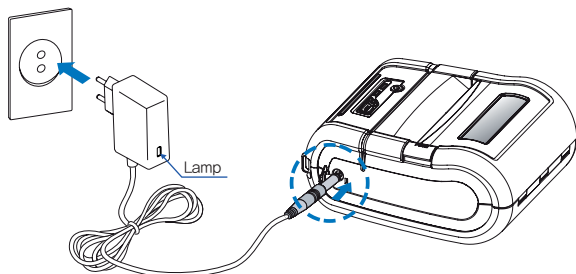

1. Be sure that the printer is turned off
2. After open the DC JACK cover, insert DC JACK into the printer.
3. Plug the power cord to electrical outlet.

4-3-1 The status of lamp in charging

Status	charging	charging complete
Charging Lamp	Red	Green

NOTE

1. Unless the exclusive charger is used provided by the manufacturer, the printer can be damaged, and the manufacturer is not liable for the consequential damage.
2. Before removing the battery, make sure that power is turned off.
3. Printer does not work in the status of being connected with charger only.
4. The battery should be installed to operate printer.
5. While charging, do not turn on the power.
6. Do not operate the print while charging the battery.
7. Do not connect the charger while the printer is operated.

4-4 Battery charger usage

Optional

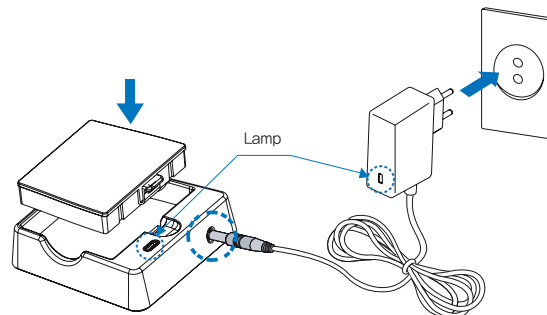

1. Insert the battery into the battery holder as shown above
2. Connect the DC JACK to the power electrical outlet.
3. Once the charging is completed, remove the battery from the holder.

4-4-1 The status of lamp in charging

Status	charging	charging complete
Charging Lamp	Red	Green

NOTE

In the case the battery is not fixed properly in the holder, the red lamp will be blinking. Then, extract and reinsert the battery.

4-5 Usage of Cigar Jack for charging

Optional

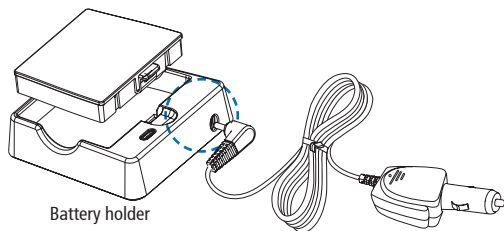
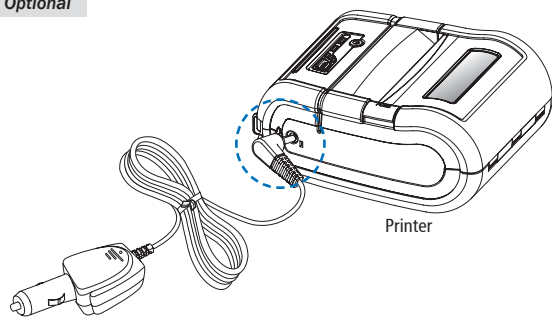

Connect the car cigar JACK charger into the printer or battery holder.

Input	12 ~ 24V
Output	8.4V 0.8 ~ 1.2A

NOTE

Use the Cigar Jack offered by the manufacturer.

4-6 Battery removal

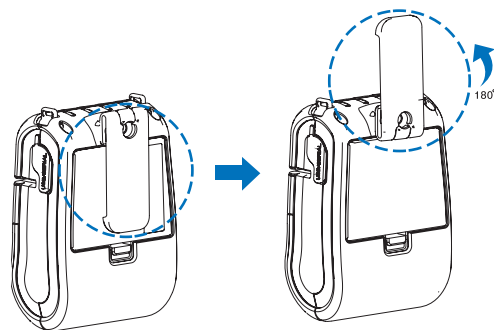

Rotate the belt clip as shown

1
2

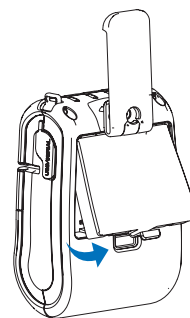

Remove the battery as shown

4-7 Belt Clip usage

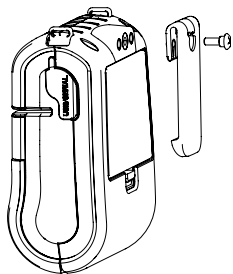

Insert screw into belt clip.

1
2

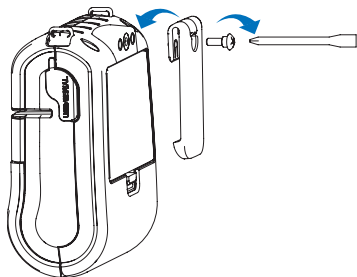

Tighten the screw with driver as shown.

4-8 Loading the media.

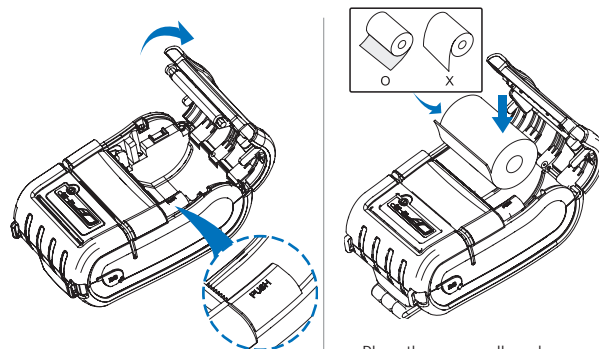

Press the cover open button and open

Place the paper roll as shown.
Make sure the paper is placed in
right direction.

1 2
3

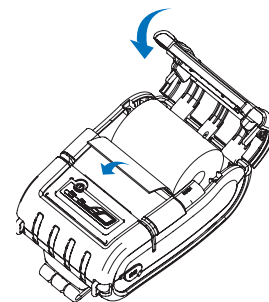

Pull a short length of paper out of
the printer and close the cover.

4-9 Shoulder Strap Usage

Optional

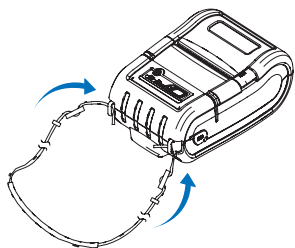

Insert the strap into the hook on the printer.

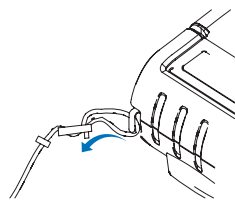

Place the end of strap into the hook of shoulder strap.

1 2
3 4

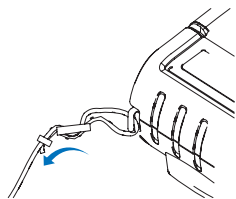

After pulling out the end of strap tightly, put it into the clip to be fastened.

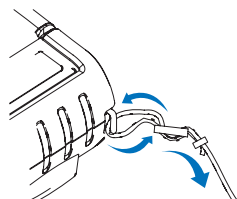

Fasten the strap in the opposite side with the same way.

4-10 Leather case usage

Optional

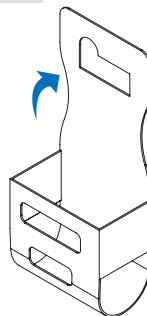

Open the leather case

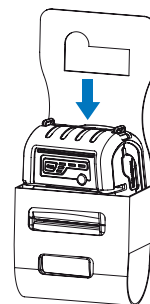

Place the printer into the leather case

1 2
3 4

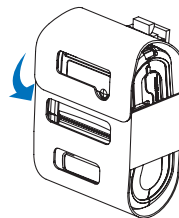

Close the Velcro and stick the cover.

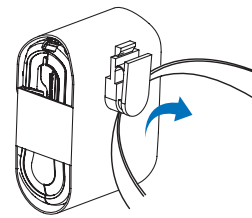

Fasten to the belt by using the clip at the rear of the leather case

4-11 Self Test

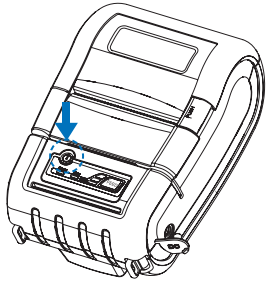

Turn off the power pressing the power button for approximately 3 seconds.

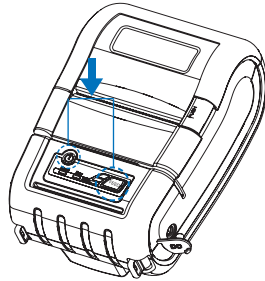

While you are pressing the FEED button, press the power button

1
2
3

NOTE

1. To print ASCII pattern additionally, press the Feed button once more
2. After printing ASCII pattern, the self test will be finished automatically.
3. If the Feed button is not pressed to print ASCII pattern, self test will be finished automatically after 3 seconds.

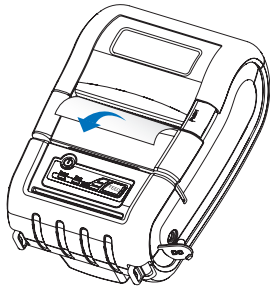

The printout is produced.

The sample of self test printout

SEWOO, LK-P20 II

Printer Configuration Info.
F/W Version : v3.03
BM(Adj) : 14B(0)
Sensor Mode : [JOURNAL]
Battery : 7.7V
Timeout(Sleep) : 60 sec
Ext' Flash : Exist
H/W Version : v1.1
MS Track : 1/2

Emulation Configuration Info.
Emulation : CPCL
Top Of Form : 0
Top Margin : 0
Left margin : 0

Serial Interface
Baud : 115200
Data bit : 8bit
Parity Bit : none
Stop bit : 1bit

USB Interface
Version 2.0 Full speed
compliant
Product String : LK-P20

WiFi Interface
Ver: 2574
SSID: MOBILE_PRINTEROFFCID
MAC: 84:72:07:0f:fc:1d
IP: 192.168.100.1
SUBNET: 255.255.255.0
GATEWAY: 192.168.100.1
Operating Mode : SoftAP
DHCP : Enabled



Press FEED button to
enter HEX-DUMP mode.

When the printer is installed initially or when you face a problem, you can run the self test and check the information about -Control Circuit, Mechanism, Print Quality, ROM Version

After checking with self-test and no issues are found, you can examine other devices and software. This function is working independent of devices and software.

- Motor protection from being overheated

The motor should be stopped and cooled about more than 30 seconds after continuous printing 1.5 meter

4-12 MSR usage

Optional

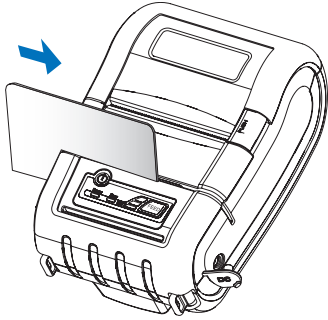

Insert and swipe the card in the direction of the arrow as shown in the picture.

4-13 IC CARD usage

Optional

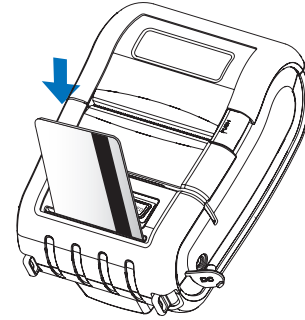

Insert the card in the direction of the arrow as shown in the picture.

5. Peripherals Connection

This product can communicate with other devices via Bluetooth or Wi-Fi communication and cable.

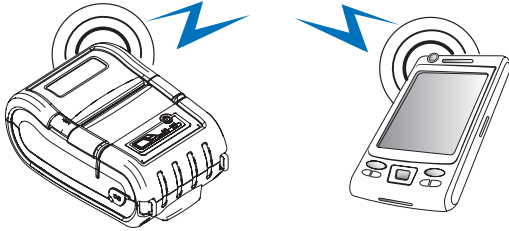

5-1 Bluetooth connection *Optional*

1. The Printer can be connected to devices equipped with Bluetooth communication capacity (PDAs, PCs, etc.)
2. Use the Bluetooth connection function supported by the device to connect to the printer.

✔ NOTE

Refer to the Bluetooth Manual for more details on connection.

5-2 Wi-Fi Connection *Optional*

1. The Printer can be connected to devices equipped with Wi-Fi communication capacity (PDAs, PCs, etc.)
2. Use the Wi-Fi connection function supported by the device to connect to the printer.

✔ NOTE

Refer to the Wi-Fi Manual for more details on connection.

5-3 Interface Cable Connection

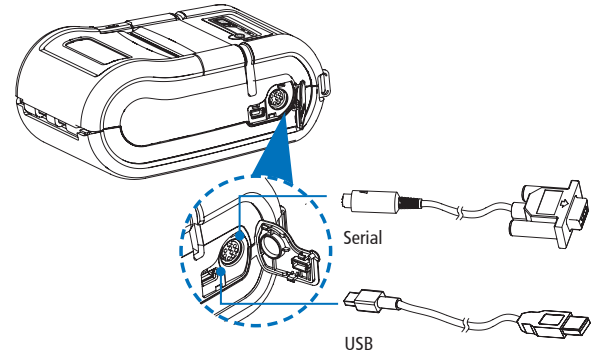

1. Connect USB or Serial cable into the cable connector on the printer.

✔ NOTE

Use the cable offered by the manufacturer (USB, Serial)

2. Connect the interface cable into the USB or Serial port of the device (PDA, PC, etc.)

6. Printer cleaning

If the interior of the printer is dusty, printing quality can be lowered. In such a case, follow the instructions below to clean up the printer.

NOTE

1. Make sure to turn the printer power off prior to cleaning
2. Regarding print head cleaning, as the print head sets very hot during printing, turn off the printer power and wait approximately 10 minutes before commencement.
3. When cleaning the print head, take care not to touch the heated portion of the print head. The print head is subject to be damaged by static electricity.
4. Take care not to allow the print head to become scratched and /or damaged in any way.

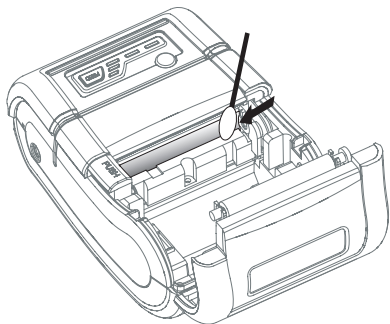

1. Use an applicator swab moistened with an alcohol solution to clean the print head and remove any dusts.
2. Once the cleaning is completed, insert paper roll into the printer few minutes later and close the printer cover.

Preventing Overheating

To prevent the motor from overheating, continuous driving of the printer should be 1.5 m or less in print length. Set the pause time for 30 seconds or more after driving the printer.

7. Standard roll media specification

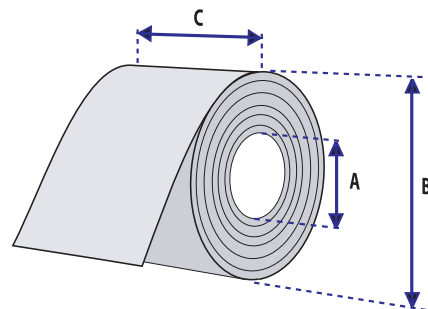

Core	
Diameter(A)	Ø12.5±0.5
Roll	
Max.diameter(B)	φ 48mm
Max.media width(C)	MAX : 58mm
Thickness	0.065 ~ 0.09mm



Caution

Protect the media against sand, grit, and other hard particles during printing and storage. Keep the cover closed. Even very small foreign particles may cause severe harm to the delicate printhead.

8. Black Mark

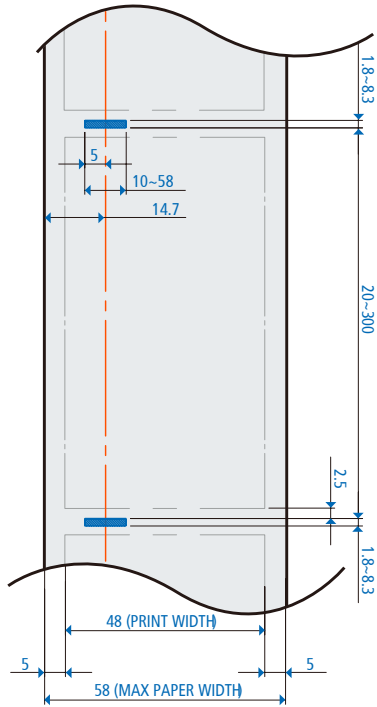

PRINTING AREA

PAPER FEEDING DIRECTION

9. Printer Specification

9-1. Specification

Printing Method	Direct Thermal	
Printing Speed	80mm/sec	
Resolution	203 DPI	
Character	ESC/POS	FontA(12x24), FontB(9x17), Asian Font(KOR, JPN, CHN_GB2312, CHN_BIG5)
	CPCL	Font0/1/2/4/5/6/7, 24x24 Asian Font(KOR, JPN, CHN_GB2312, CHN_BIG5), Resident TTF, Downloadable TTF
	ZPL	FontA~H, FontGS, Resident TTF(Font0), Downloadable TTF
	EPL	Font1 ~ 8
Barcode	ESC/POS	1D: EAN-8, EAN-13, Code39, ITF, UPC-A, UPC-E, Codabar, Code93, Code128 2D: QR, PDF417
	CPCL	1D: LUPC-A(+2,+5), UPC-E(+2,+5), EAN13(+2,+5), EAN8(+2,+5), Code39 etc. (CPCL) 2D: QR, PDF417, MicroPDF417, Maxicode, Datamatrix, Aztec, TLC39, RSS14
	ZPL	1D : Code11, ITF, Code39, Planet, EAN-8, UPC-E, Code93, Code128 etc. (ZPLII) 2D: QR, PDF417, MicroPDF417, Maxicode, Datamatrix, Aztec, TLC39, RSS14
	EPL	1D : Code39, Code93, Code128, Codabar, EAN-(+2,+5), EAN13(+2,+5), ITF etc. (EPLII) 2D : QR, PDF417, Maxicode, Datamatrix, Aztec, RSS14
Emulation	ESC/POS, CPCL, ZPL, EPL, Command Compatible	
Driver	Window Printer Driver (10, 2012, 8.0/8.1, 7, 2008, Vista, 2003, XP, 32 & 64bit), Windows (CE 4.2 & 5.0 & 6.0 & 7.0 / Mobile 5.0 & 6.0)	
Sensor	Paper End Sensor	

Paper	Paper type	Thermal Paper	
	Width	Max. 58mm	
	Thickness	65µm	
	External Diameter	Max. ϕ 48mm	
	Internal Diameter	12.5mm +/-0.5mm	
Reliability	TPH	50km	
	Battery	Continuous Printing 52min Standby for 16hours 20min Printing length: 236m	
Communications	Standard	Serial(RS-232C), USB	
	Optional	Bluetooth Smart ready 4.2 or Wi-Fi (802.11a/b/g/n)	
Battery Charger	Input	AC100~240V, 50/60Hz	
	Output	8.4V , 800~1400mA	
Battery	Battery type	Li-ion	
	Output	7.4V, 2000mAh (Option : 2500mAh)	
	Charging time	150min	
MSR (Optional)	Card Standard	ISO 1&2 or ISO 2&3	
	Track	1&2 Track or 2&3 Track	
	Magnetic Head Life	300,000 Passes(minimum)	
EMV II (Optional)	MSR	Card Standard	ISO 1&2&3 or ISO 1&2&JIS-II
		Track	ISO Track 1&2&3
		Magnetic Head Life	500,000 Passes(minimum)
	ICR	Card Standard	ISO 7816
		Head Life Cycle	100,000 Passes(minimum)
Size	WxDxH(mm)	93 x 138 x 62	
	WxDxH"	3.66 x 5.43 x 2.44	

Weight	340g (With Battery : 440g)	
Environmental sealing	IP42, IP54 (With Protection case)	
Temperature	Operation	-10~50°C
	Storage	-20~60°C
Humidity	Operation	10 ~ 80%
	storage	10 ~ 90%

● Preventing Overheating

To prevent the motor from overheating, continuous driving of the printer should be 1.5 m or less in print length. Set the pause time for 30 seconds or more after driving the printer.

10. Certification

FCC Information

This device complies with part 15 of the FCC Rules. Operation is subject to the following two conditions:

- (1) This Device may not cause harmful interference, and
- (2) This device must accept any interference received, including interference that may cause undesired operation.

This Class [B] digital apparatus complies with Canadian ICES-003.
Cet appareil numérique de la classe [B] est conforme à la norme NMB-003 du Canada.

Operation is subject to the following two conditions: (1) this device may not cause harmful interference, and (2) this device must accept any interference received, including interference that may cause undesired operation of the device.

NOTE

This equipment has been tested and found to comply with the limits for CLASS B digital device, pursuant to Part 15 of FCC Rules. These limits are designed to provide reasonable protection against harmful interference when the equipment is operated in a commercial environment. This equipment generates, uses and can radiate radio frequency energy and, if not installed and used in accordance with the instructions, may cause harmful interference to radio communications. However, there is no guarantee that interference will not occur in a particular installation. If this equipment does cause harmful interference to radio or television reception, which can be determined by turning the equipment off and on, the user is encouraged to try correct the interference by one or more of the following measures:

- 1.1. Reorient or relocate the receiving antenna.
- 1.2. Increase the separation between the equipment and receiver.
- 1.3. Connect the equipment into an outlet on a circuit different from that to which receiver is connected.
- 1.4. Consult the dealer or experienced radio/TV technician for help.

WARNING

Changes or modifications not expressly approved by the manufacturer could void the user's authority to operate the equipment.

CAUTION

Antenna shall be mounted in such a manner to minimize the potential for human contact during normal operation. The antenna should not be contacted during operation to avoid the possibility of exceeding the FCC radio frequency exposure limit.

The device meets the FCC requirements for radio frequency (RF) radiation exposure in the standard body worn configuration with no minimum configuration. In this configuration, which applies whether the belt clip or shoulder strap is used, the face of the printer from which paper is transported is facing away from the user's body. The standard configuration must always be used when the printer is body worn.

11. Setting up the software

Please refer to the programming manual included in CD.

PATENT

